

Armidale Place

MONTPELIER

APPROXIMATE FLOOR AREA
61.9 SQM / 667 SQFT



FIFTH FLOOR

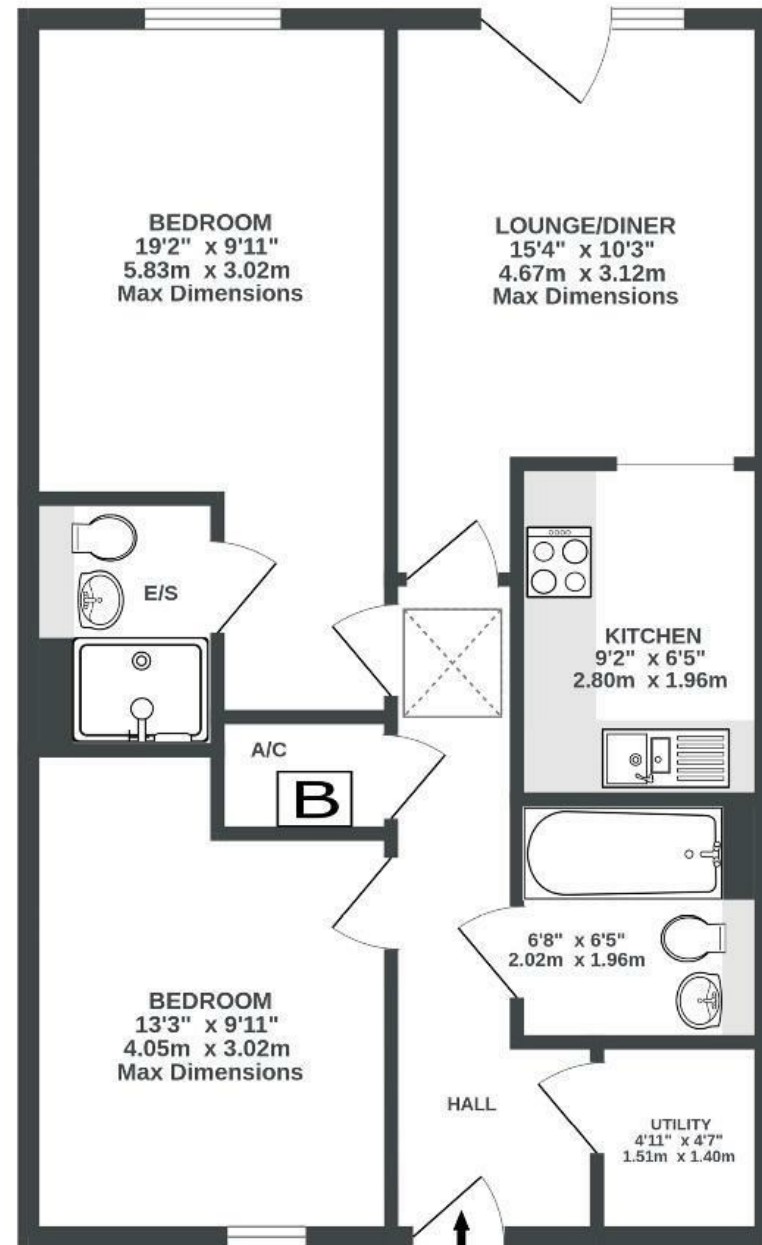

Illustrations are for reference purposes only, measurements are approximate, not to scale.

Boardwalk

Armidale Place , BRISTOL



£290,000



2 Bedrooms



Bristol, BS6
5DA



2 Bathrooms

"We've had a wonderful time in our airy apartment in this beautiful, friendly part of Bristol, it has a peaceful vibe and is surprisingly quiet given its location. We've really made it our own. We're going to really miss picking up our organic veg from Radford Mill Farm Shop, and amazing food and wine from the Italian deli on Picton Street, having so many independent cafes, bars, and restaurants right at our doorstep has been such a treat. We feel so lucky to have it all so close by."

